

## Enlarging telecentric lenses

vicotar®

T80 series - enlarging telecentric lenses

### Product features

- Object side telecentric light path
- Application for matrix and line cameras up to sensor diagonal/length 11 mm
- Maximum object field diameter 11.1 mm
- Measuring lenses with long working distance
- Fixed aperture
- Robust industrial design: dust-proof, shock-proof
- C-mount (thread connection)



### Engineering drawing

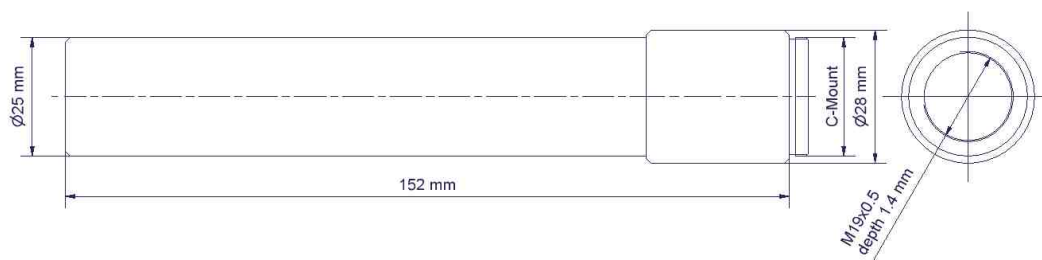

Download  
Manual



Download  
CAD-File



### Properties

#### Optical properties

Spectral range 380...900nm / colour-corrected / fast lenses

#### Mechanical properties

Flange focal distance 17.53mm / focal filter thread M19 x 0.5 /  
environmental temperature -10°C ... 50°C

### Options

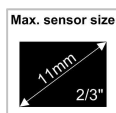

## Enlarging telecentric lenses

vicotar®

T80 series - enlarging telecentric lenses

### Optical data

Name	Order no.	Lateral magnification	Object side depth of field [mm]*	Field of view for 1" sensor [mm <sup>2</sup> ]	Field of view for 2/3" sensor [mm <sup>2</sup> ]	Field of view for 1/1.8" sensor [mm <sup>2</sup> ]	Field of view for 1/2" sensor [mm <sup>2</sup> ]	Field of view for 1/3" sensor [mm <sup>2</sup> ]	Field of view for 1/4" sensor [mm <sup>2</sup> ]
T80/1.0L	2-05-270	-1 : 0.99	1.0 (0.25)	--	8.9 × 6.7	7.0 × 5.4	6.5 × 4.9	4.9 × 3.6	3.6 × 2.7

\*Object side depth of field at a circle of confusion 40 (10) μm.

We provide technical information to the distortion or the telecentric error of a certain lens by our technical support upon request..

Size of imaging device:

1.34" - 15.16 x 15.16 mm<sup>2</sup> | 1" - 12.8 x 9.6 mm<sup>2</sup> | 2/3" - 8.8 x 6.6 mm<sup>2</sup> | 1/1.8(=5/9)" - 7.1 x 5.4 mm<sup>2</sup> | 1/2" - 6.4 x 4.8 mm<sup>2</sup> | 1/3" - 4.8 x 3.6 mm<sup>2</sup>

### Mechanical data

Name	Order no.	Max. object field diagonal	Object side aperture (fixed)	Working distance	Total length	Max. diameter of lenses	Weight
T80/1.0L	2-05-270	11.1 mm	0.04	115 ± 3 mm	152 mm	28 mm	150 g

### Important advice

#### Anxiliary adjusting device

The optical axis must be aligned perpendicularly to object level / plane of measurement to realize exact measurement. This anxiliary adjusting device lower time and effort for setup. Please find further information in the corresponding data sheet.

#### Protection glass

High-quality front lens of the objective can be protected against impurities and damages by means of protection glass UV M19 x 0.5. You shall be screw-on first lens (object side).

#### Care instruction

Clean easily dirty lens with an optics brush or cleaned air. Adherent contamination can be removed by using an optical cleaning tissue. Please use only alcohol as a solvent, do not use acetone or other chemicals

## Enlarging telecentric lenses

vicotar®

T80 series - enlarging telecentric lenses

### Accessories

Order no.	Name	Description
2-15-111	ABE 3328-80	beam-splitter unit for lighting together with T80- series
2-25-112	PSO 90-80	beam-deflection unit (90°) for lens-systems T80-series
2-90-128	OH 25	lens holder, d = 25 mm
2-91-122	UV M19 x 0,5	protection glass for telecentric lens-systems
2-91-132	IR M19 x 0.5	daylight cutting-filter for telecentric lens-systems
5-10-110	JH 2,7	adjustment-help for 2,7mm depth of focus

You can find a multiplicity of filters in the chapter accessories. Please order the filters separately.

### Intended use for accessories

#### Note:

This area is reserved for future examples that will demonstrate the cooperation of lighting components and accessories.

We're going to show you the variety of combinations of the Vision & Control component system!

Your catalogue editors of Vision & Control GmbH