

## Telecentric measurement lenses

vicotar®

T125 series

### Product features

- Object side telecentric light path
- Application for matrix and line cameras up to sensor diagonal/length 11 mm
- Maximum object field diameter 15.5 mm
- Measuring lenses with long working distance
- Fixed aperture
- Robust industrial design: dust-proof, shock-proof
- C-mount (thread connection)



### Engineering drawing

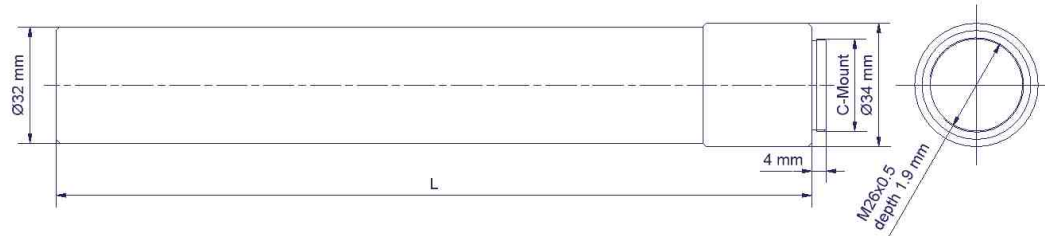

Download Manual



Download CAD-File



### Properties

#### Optical properties

Spectral range 380...900nm / colour-corrected / fast lenses

#### Mechanical properties

Flange focal distance 17.53mm / max. diameter of lenses 34mm / focal filter thread M26 x 0.5 / environmental temperature -10°C ... 50°C

### Options

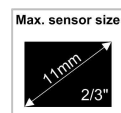

## Telecentric measurement lenses

vicotar® T125 series

### Technical data

Name	Order no.	Lateral magnification	Object side depth of field [mm]*	Field of view for 1" sensor [mm <sup>2</sup> ]	Field of view for 3/8" sensor [mm <sup>2</sup> ]	Field of view for 1/1.8" sensor [mm <sup>2</sup> ]	Field of view for 1/2" sensor [mm <sup>2</sup> ]	Field of view for 1/3" sensor [mm <sup>2</sup> ]	Field of view for 1/4" sensor [mm <sup>2</sup> ]
T125/0.7L	2-05-310	-1 : 1.41	2.7 (0.7)	--	12.4 × 9.3	10.0 × 7.6	9.0 × 6.8	6.8 × 5.1	5,1 × 3,8

\*Object side depth of field at a circle of confusion 40 (10) μm and a middle aperture setting.

We provide technical information to the distortion or the telecentric error of a certain lens by our technical support upon request..

Size of imaging device:

1.34" - 15.16 x 15.16 mm<sup>2</sup> | 1" - 12.8 x 9.6 mm<sup>2</sup> | 3/8" - 8.8 x 6.6 mm<sup>2</sup> | 1/1.8(=5/9)" - 7.1 x 5.4 mm<sup>2</sup> | 1/2" - 6.4 x 4.8 mm<sup>2</sup> | 1/3" - 4.8 x 3.6 mm<sup>2</sup>

### Mechanical data

Name	Order no.	Max. object field diagonal	Image side aperture (fixed)	Working distance	Total length L	Weight
T125/0.7L	2-05-310	15.5 mm	0.03	197 ± 2 mm	208 mm	300 g

### Important advice

#### Anxiliary adjusting device

The optical axis must be aligned perpendicularly to object level / plane of measurement to realize exact measurement. This anxiliary adjusting device lower time and effort for setup. Please find further information in the corresponding data sheet.

#### Protection glass

High-quality front lens of the objective can be protected against impurities and damages by means of protection glass UV M26 x 0.5. You shall be screw-on first lens.

#### Care instruction

Clean easily dirty lens with an optics brush or cleaned air. Adherent contamination can be removed by using an optical cleaning tissue. Please use only alcohol as a solvent, do not use acetone or other chemicals.

## Telecentric measurement lenses

vicotar® T125 series

### Accessories

Order no.	Name	Description
2-15-112	ABE 3328-100	beam-splitter unit for lighting together with T100- and T125-series
2-15-123	ABE TZB30-100	beam splitter unit plus adapter TZB30 for T100- and T125-series
2-25-113	PSO 90-100/125	beam-deflection unit (90°) for lens-systems T100 / T125- series
2-90-122	OH 32	lens holder, d = 32 mm
2-91-123	UV M26 x 0,5	protection glass for telecentric lens-systems
2-91-131	IR M20.5 x 0.5	daylight suppression filter for telecentric lens-systems
2-91-133	IR M26 x 0.5	daylight cutting-filter for telecentric lens-systems
5-10-111	JH 5	adjustment-help for 5mm depth of focus

You can find a multiplicity of filters in the chapter accessories. Please order the filters separately.

### Intended use for accessories

#### Note:

This area is reserved for future examples that will demonstrate the cooperation of lighting components and accessories.

We're going to show you the variety of combinations of the Vision & Control component system!

Your catalogue editors of Vision & Control GmbH